

Central Article Code: C52030D03-A

Created: 22/11/2006

Local Code: 4987

Modified: 15/12/2020

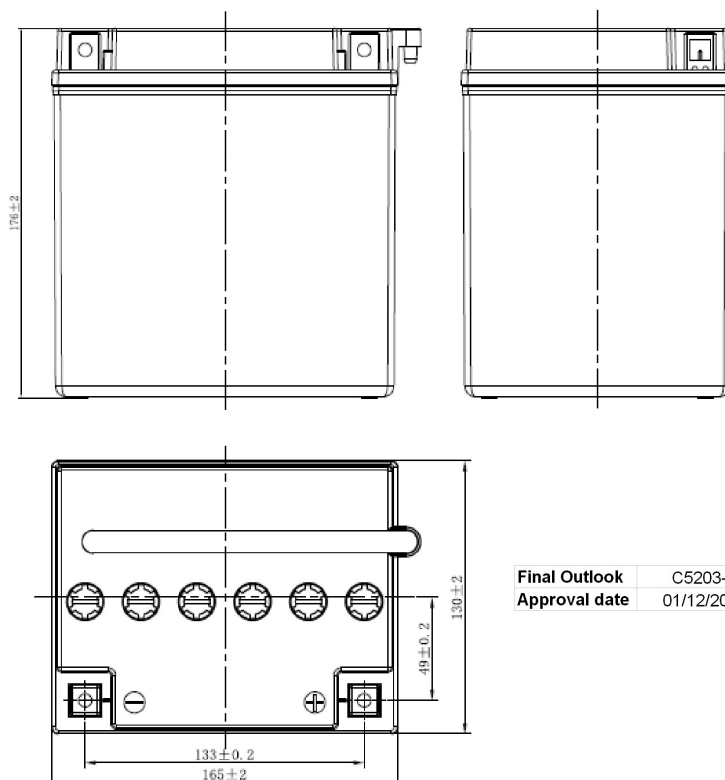

Final Outlook	C5203-A
Approval date	01/12/2009

## PERFORMANCES

Voltage (V):	12 V	
C20 (Ah):	30.0	10 h
Cranking (A):	300	EN
Charge:	DRY	
Technology:	Vented/Flooded	
Grid:	Low Sb	
Vibration:	Not Defined	
Endurance:	Not Defined	

## STD. DIMENSIONS

Length (mm $\pm 2$ ):	165
Width (mm $\pm 2$ ):	130
Height (mm $\pm 2$ ):	175
Total Weight (kg $\pm 5\%$ ):	8.80

This is a dry battery supplied with bottles of sulphuric acid. Sale of acid to end users is forbidden by Eu.Reg.1148/2019. Dry batteries must be filled with acid before delivery to end users

All figures show nominal values. Tolerances are according to EN50342 and applicable European Regulations.

## CONTAINER

Type:	C52	WHITE
Hold Down:	B0	
H.D. Adapter:	No	

## COVER

Type:	Motorbike (B ventilati	BLACK
Polarity:	ETN 0	
Terminals:	M04	
Terminal Adapter:	No	
SOCI:	No	
Ventilation:	Moto-B	
Filter:	No	
Lateral Plug:	No	

## PLUGS

Type:	6 x Moto Plug	RED
-------	---------------	-----

## HANDLES

Type:	None
-------	------

## OTHERS

Degassing Tube:	No
-----------------	----

EAC certified