

Central Article Code: L01045C14-E

Created: 10/05/2018

Local Code: EB500

Modified: 31/07/2020

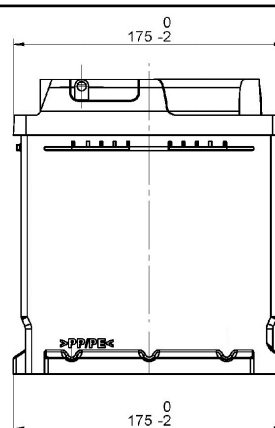
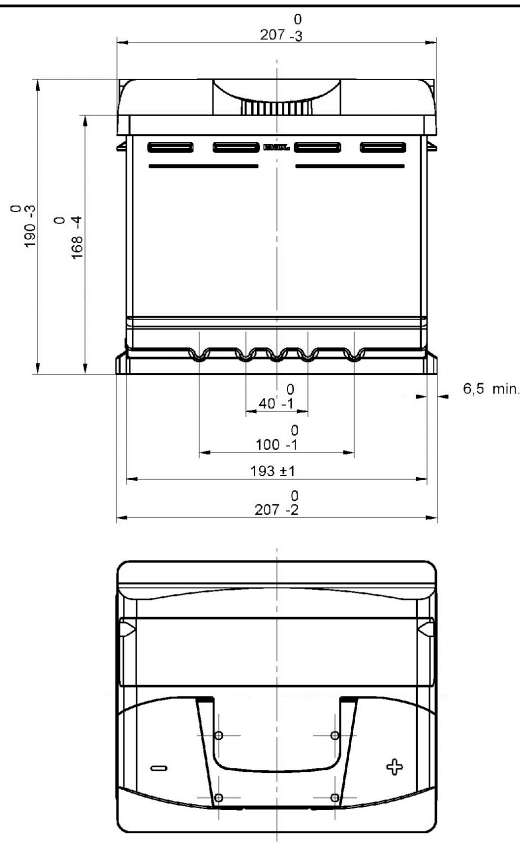

Final Outlook	L0114-E
Approval date	01/07/2018

PERFORMANCES

Voltage (V):	12 V
C20 (Ah):	50.0 20 h
Cranking (A):	450 EN
Charge:	WET
Technology:	Vented/Flooded
Grid:	Ca/Ca
Vibration:	V1 (30Hz+/-2Hz/3g/2h)
Endurance:	E1 (180 cycles@25%)

STD. DIMENSIONS

Length (mm ± 2):	207
Width (mm ± 2):	175
Height (mm ± 2):	190
Total Weight (kg ± 5%):	12.10

All figures show nominal values. Tolerances are according to EN50342 and applicable European Regulations.

CONTAINER

Type:	L01 BLACK
Hold Down:	B13
H.D. Adapter:	No

COVER

Type:	NPR BLACK
Polarity:	ETN 0
Terminals:	EN taper post
Terminal Adapter:	No
SOCI:	No
Ventilation:	Central
Filter:	2 Filters
Lateral Plug:	Standard Right side BLACK shape

PLUGS

Type:	1 x NPR (Manifold) BLACK
-------	-------------------------------

HANDLES

Type:	1 x NPR (Standard) BLACK
-------	-------------------------------

OTHERS

Degassing Tube:	No
-----------------	----