

Central Article Code: L04076C14-E

Created: 13/12/2013

Local Code: EL800

Modified: 26/02/2015

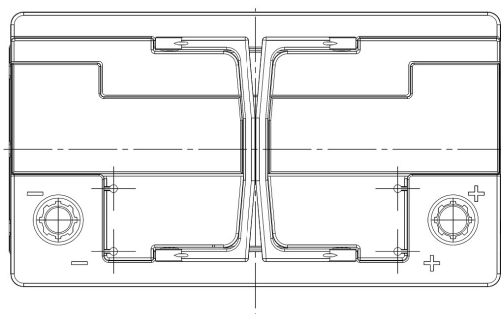
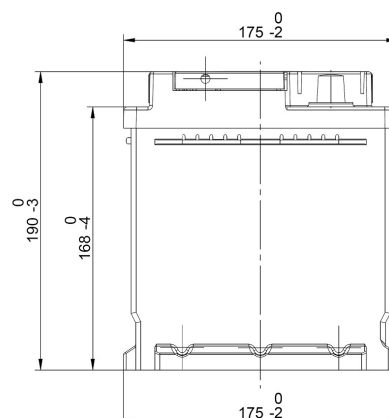
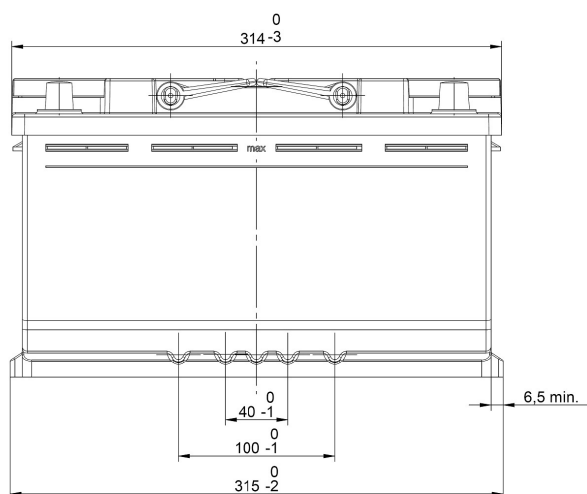

Final Outlook	L0414-E
Approval date	15/02/2014

## PERFORMANCES

Voltage (V):	12 V	
C20 (Ah):	79.0	20 h
Cranking (A):	720	EN
Charge:	WET	
Technology:	Vented/Flooded	
Grid:	Ca/Ca	

## CONTAINER

Type:	L04	BLACK
Hold Down:	B13	
H.D. Adapter:	No	

## COVER

Type:	Double with Inte BLACK
Polarity:	ETN 0
Terminals:	EN taper post
Terminal Adapter:	No
SOCI:	No
Ventilation:	Central
Filter:	1 Filter at Left
Lateral Plug:	No

## STD. DIMENSIONS

Length (mm ± 2):	315
Width (mm ± 2):	175
Height (mm ± 2):	190

## PLUGS

Type:	1 x Vent Seale	BLACK
-------	----------------	-------

## HANDLES

Type:	2 x Integrated	BLACK
-------	----------------	-------

## OTHERS

Degassing Tube:	No
-----------------	----

All figures show nominal values. Tolerances are according to EN50342 and applicable European Regulations.