

Central Article Code: D06110R15-A

ETN Code or Other: 96801

Created: 31/03/2009

Modified: 8/17/2009

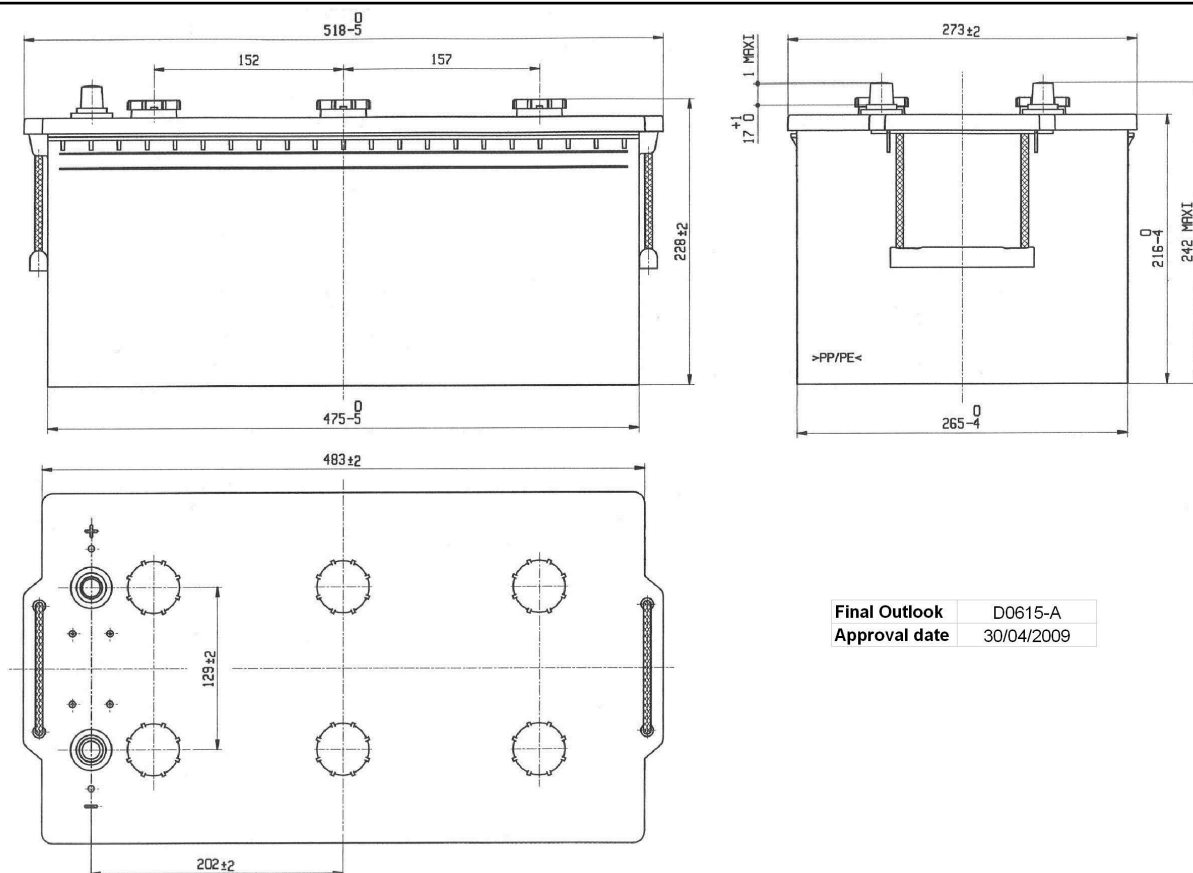

Final Outlook	D0615-A
Approval date	30/04/2009

## PERFORMANCES

Voltage (V):	12 V
C20 (Ah):	230.0      20 h
Rc (min):	0
Cranking (A):	1100      EN
Vibration:	V3 (35Hz/6g/20h)
Endurance:	300 cycles@75%
Charge:	WET
Technology:	Semi-Traction
Grid:	4% Sb

## WEIGHT AND STD. DIMENSIONS

Lead Weight (kg):	38.81
Battery Weight (kg):	64.84
Volume acid (l):	15.76
Length (mm):	518
Width (mm):	279
Height (mm):	240

All figures show nominal values. Tolerances are according to EN50342 and applicable European Regulations.

## CONTAINER

Type:	D06	WHITE
Hold Down:	B0	
H.D. Adapter:	No	

## COVER

Type:	Flat/Screw	WHITE
Polarity:	ETN 3	
Terminals:	EN taper post	
Terminal Adapter:	No	
SOCI:	No	
Ventilation:	Independent	
Filter:	No	
Lateral Plug:	No	

## PLUGS

Type:	6 x M27(STS)	RED
-------	--------------	-----

## HANDLES

Type:	2 x Rope (Rigid)	BLACK
-------	------------------	-------

## OTHERS

Degassing Tube:	No
-----------------	----