

# VEJLEDNING

## USER MANUAL

### I. Description of Panel Functions

1. Light Button
2. Upward / Volume Reduction Button VOL- "◀◀" / VOL-"
3. Upward / Volume Increase Button VOL+ "▶▶" / VOL+"
4. Power Switch /Mode Button "PWR/MOD"
5. Card Slot of TF Card
6. Speaker
7. Bracket
8. Bracket

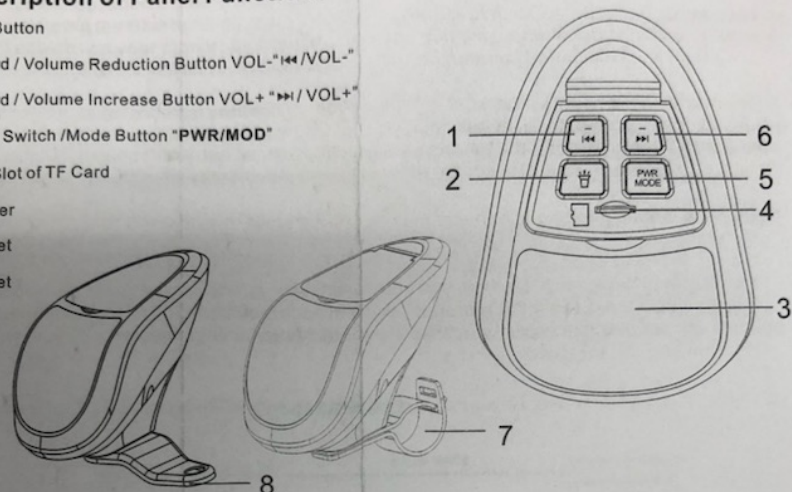

### II. Functions and Operation

1. Light Button: short press to switch
2. Upward / Volume Reduction Button VOL- "◀◀" / VOL-"
  - 1) In the radio receiving status, short press "◀◀" button to reduce volume and long press "◀◀" button to search the low-end frequency station.
  - 2) In the BT/U disk playing status, short press "◀◀" button to reduce volume and long press "◀◀" button to select the previous song.
3. Upward / Volume Increase Button VOL+ "▶▶" / VOL+"
  - 1) In the radio receiving status, short press "▶▶" button to increase volume and long press "▶▶" button to search the high-end frequency station.
  - 2) In the BT/U disk playing status, short press "▶▶" button to increase volume and long press "▶▶" button to select the previous song.
4. Power Switch /Mode Conversion Button "PWR/MOD"
  - 1) After power up, short press the "PWR/MOD" button to turn it on; long press the "PWR/MOD" button to turn it off; in the power-on status, short press "PWR/MOD" to converse modes.
  - 2) In the power-on and radio receiving status, short press "PWR/MOD" button to converse modes in "Radio Receiving-U disk-BT-AUH" loop. When the related device is not connected to the host, the mode of the default device is not in the loop. In the Bluetooth and BT/U disk playing status, short press the corresponding button to pause, short press again to release pause, and double press to converse modes in "Radio Receiving-U disk-BT-AUH" loop. When the related device is not connected to the host, the mode of the default device is not in the loop.

### III. Bluetooth Operation:

Bluetooth pairing method:

- 1) After power up, short press "**PWR/MOD**" button to enter Bluetooth mode
- 2) After entering the Bluetooth mode, the host will give out a "tinkling" prompt tone; you turn on the Bluetooth on your phone, and then use your phone to search for the local device (name: MT493) and make a paired connection
- 3) The default initial pairing password is "0000". After the pairing is successful, the host will give out a "tinkling" prompt tone; at this time, you activate your music player to play music by the means of Bluetooth. Note: the pairing password is not necessary for some of mobile phones which automatically connect with the Bluetooth when the host is searched.
- 4) When the mobile phone disconnects the Bluetooth device, the host will give out a "tinkling" prompt tone.
- 5) After the local device is turned on, you insert the USB flash disk in the Bluetooth playing status or short press the MOD button to switch to each mode; meanwhile, the Bluetooth device will automatically exit; when the Bluetooth device is disconnected, the host will give out a "tinkling" prompt tone.

### IV. Functional Wiring Diagram of Host:

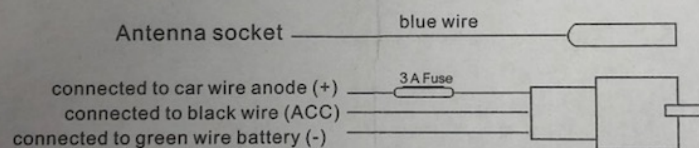

### V. Installation diagram:

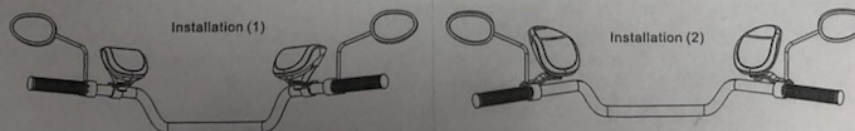

### VI. Technical Parameters:

1. connection distance of the Bluetooth  $\geq 10\text{M}$
2. Audio frequency response: 100HZ-18KHZ
3. Audio distortion  $\leq 0.32\%$
4. Audio signal to noise ratio  $\geq 45\text{dB}$
5. Audio output power  $\geq 7\text{W} \times 2$
6. Dustproof and waterproof grade: IP65